

ITEM	P/N	DESCRIPTION	QTY
1	6500-881	IPB-Model 6500-081	1
2	6500-150	Base Stand	1
3	6500-230	Mounting Plate-Slave	1
4	6500-105	Bracket Switch Box	1
5	2600-533	Sub Assy-Switch Cover	1
6	2600-717	Gearbox	1
7	6500-115	Collar Limit Switch Mount	1
8	6500-030	Bracket-Plastic Limit Switch, Lower	1
9	1601-263	Switch-Mag Sensor (Yel/Wht or Yel/Slate)	1
10	6500-032	Bracket-Plastic Limit Switch, Upper	1
11	1601-261	Switch-Mag Sensor (blu/Wht or Orn/Slate)	1
12	6500-135	Bushing Bronze 1 1/8 ID	1
13	6500-400	Sub Assy-Hub 1/2 HP	1
15	2599-063	Label-8 Position Term	1
15	3130-012	Terminal Block-8 Position	1
16	3129-008	Terminal Block Cover 8 Position	1
17	2600-810	Bushing 7/8 Poke Thru Flaps	7
20	6500-200	Tool-Hub Clutch Release	1
40	2600-731	Gasket Switch Cover	1
60	2620-411	Nut Hex Flange Lock 5/16-18	8
61	2620-409	Nut Hex Flange Lock 1/4-20	6
70	2616-018	Screw Phillips Head 8-32 x 1/2	4
71	2616-051	Screw Phillips Head 10-32 x 3/8	2
95	9402-053	Tubing Flex/Split 1/4 OD	2'
96	9402-055	Tubing Flex/Split 1/2 OD	3'
97	2600-757	Wire 9 Cond Cable	1
98	6500-045	Wire Set Slave 6500 Operator	1

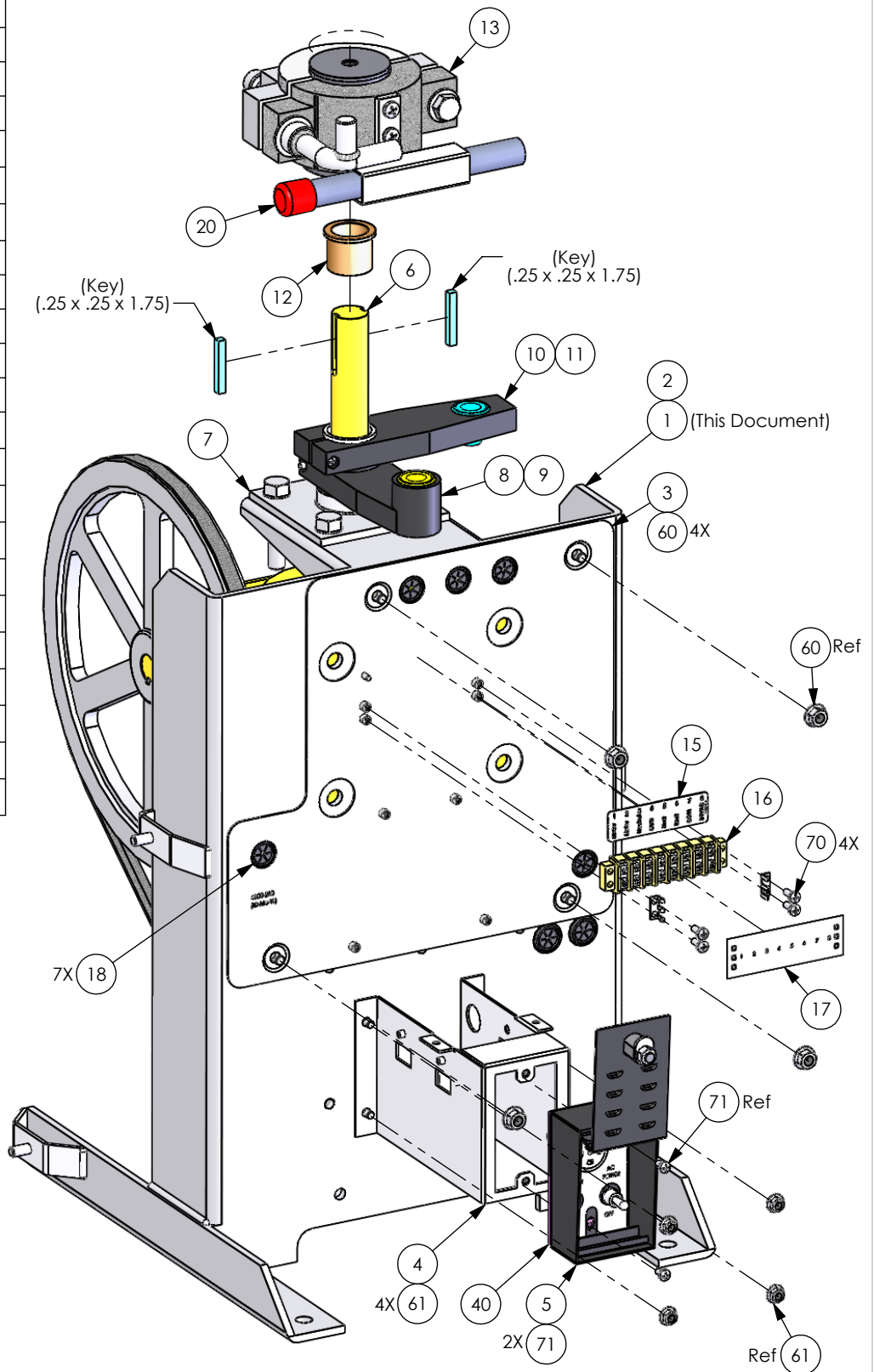

2. Flex Tubing, 9 Conductor Cable, & Wire Set Slave 6500 Operator (Items 95-98) not shown for clarity.

1. Reference Movex 6500-081 Rev A when modifying BOM.

Notes: Unless Otherwise Specified.

**PROPRIETARY AND CONFIDENTIAL**

THE INFORMATION CONTAINED IN THIS DRAWING IS THE SOLE PROPERTY OF Door King. ANY REPRODUCTION IN PART OR AS A WHOLE WITHOUT THE WRITTEN PERMISSION OF Door King IS PROHIBITED.



IPB-Model 6500-081,  
115V, 1/2HP, Slave

SIZE	DWG NO	REV
A	6500-881	A
Scale: None		SHEET 1 OF 3

ITEM	P/N	DESCRIPTION	QTY
50	2600-129	Motor Assy-1/2 HP	1
51	6500-120	Capacitor Mounting Plate Assy	1
52	2600-875	Capacitor Mounting Clamp	1
53	2600-102	Capacitor-50uf, 370 VAC	1
54	2600-597	Pulley-13" x 7/8 AK134	1
55	6500-047	Belt-47" 4L470	1
63	2902-003	Nut Nylon Lock 6-32	3
64	2902-006	Nut Nylon 10-32	2

ITEM	P/N	DESCRIPTION	QTY
65	2620-420	Nut Hex 1/2-13	4
66	2620-405	Nut Hex 3/8-16	4
69	2616-097	Set Screw-5/16-18 x 3/8	2
77	2616-058	Screw Phillips Head 10-32 x 2	2
80	2620-050	Lockwasher 1/2	4
81	2620-047	Lockwasher 3/8	4
82	2620-019	Washer 3/8 SAE	8
90	2615-081	Bolt Hex Head 1/2-13 x 1 3/4	4
91	2615-053	Bolt Hex Head 3/8-16 x 1 1/4	4
140	6500-146	Collar Gear Box	1
145	6500-147	Gear Box Shaft Extension	1

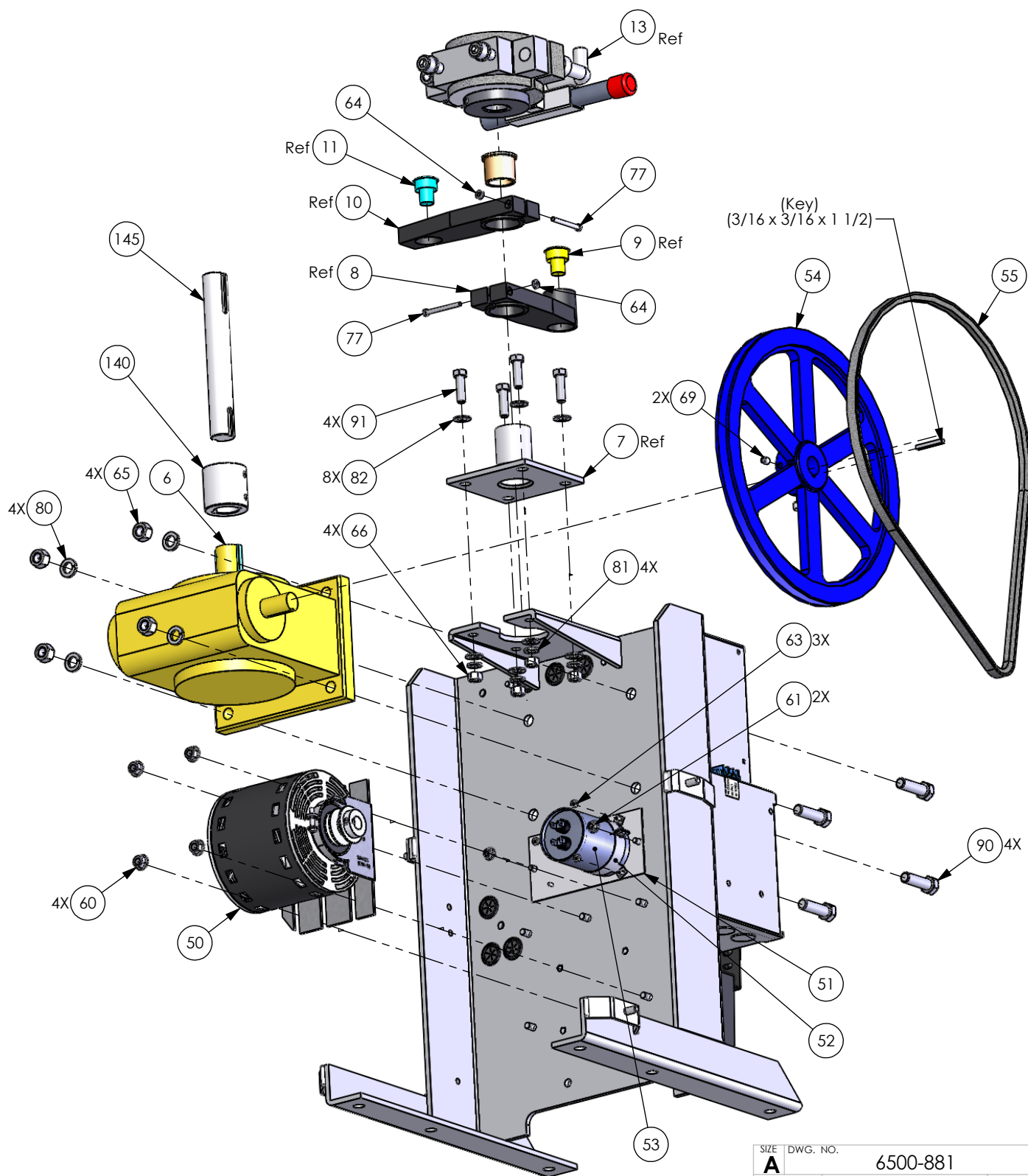

ITEM	PART NUMBER	DESCRIPTION	QTY
56	6500-450	Cover Front w/ Handle	1
57	6500-460	Cover Back w/ Labels	1
58	6500-430	Sub Assy-Arm Main	1
59	6500-440	Sub Assy-Cover Turret	1
78	2616-580	Nut Barrel 5/16-18 Thread	4

